

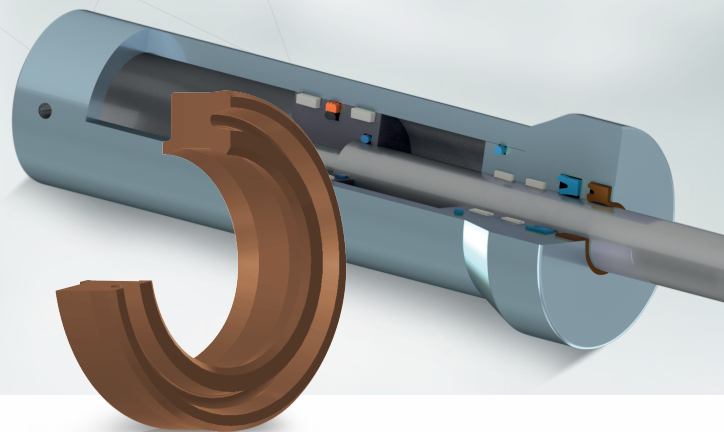

Double-lip Wipers for ISO Grooves



- Outstanding abrasion and extrusion resistance
- Wide range of fluid compatibilities
- Materials available for extended fluid compatibility required in food technology and biodegradable hydraulic media
- Excellent assembly ability
- Excludes environmental containments
- Custom dimensions can be delivered quickly using our turning capabilities

The FiPur® preferred dimensions of the double wiper profile
*DW fit in the grooves according to DIN ISO 6195 type C. By the combination of wiper lip and secondary sealing lip a very thin residual lubricating film is achieved on the rod, which leads to extremely low leakage.

Whenever special requirements are required, in addition to the primary function of dirt protection are needed, FiPur® double wipers come for use.

All materials are extremely robust and the user maximum functional reliability, even under tough operating conditions. For severe contamination, other compounds can be used.

Application examples

- Fork lifter in the food processing industry
- Agricultural and forestry machines
- Earth moving machines
- Industrial hydraulic cylinders that require clean operation
- Use in water protection areas

Technical Data

Operating Temperature	-35°C - +110°C
Sliding Speed	≤ 2 m/s
Media	Hydraulic oils based on mineral oil ** biodegradable media

*DW Wiper (Double Wiper) ** when using FiPur® 200

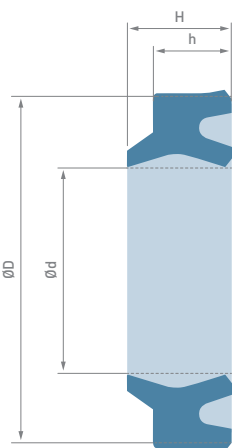

Fig. 1 Cross section of the wiper

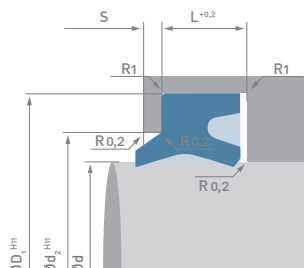

Fig. 2 Cross-section of the installation situation

Installation instructions

The profiles fits into the standard grooves spaces according to DIN ISO 6195, Type C. We recommend that the wiper lip is always positioned outside of the cylinder housing.

In this way the stripped media can be kept away from the system effectively.

Avoid running the wiper over sharp edges while assembling. Sharp edges can result in damage of the wiper lips.

Product Catalog

